

Schneckenräder / Worm gear

Modul / Module 0,4

Eingriffswinkel / pressure angle: 20°

Material: Messing (MS58) / Brass

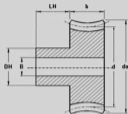

Skizze: E

Best.Nr.	Zähnezahl	d	da	DN	b	LN	B	Skizze
Order No.	Number of teeth							
40412010	10	4,0	4,8	3,5	2,0	3,0	2,0	E
40412020	20	8,0	8,8	6,0	2,0	3,0	3,0	E
40412030	30	12,0	12,8	6,0	2,0	3,0	3,0	E
40412040	40	16,0	16,8	6,0	2,0	3,0	3,0	E
40412050	50	20,0	20,8	6,0	2,0	3,0	3,0	E
40412075	75	30,0	30,8	8,0	2,0	3,0	3,0	E
40412100	100	40,0	40,8	8,0	2,0	4,0	3,0	E

Alle Abmessungen: mm / all dimensions: mm

**Schnecken / Worm
Modul / Module 0,4**

Eingriffswinkel / pressure angle: 20°

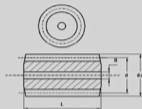

Skizze: F

Best.Nr. Order No.	Zähnezahl / Gangzahl Number of teeth	Material	d	da	L	B	Skizze
40418001	1	Messing / Brass	4,2	5,0	10,0	2,0	F
40428001	1	Stahl / Steel	4,2	5,0	10,0	2,0	F

Alle Abmessungen: mm / all dimensions: mm

Schneckenräder / Worm gear

Modul / Module 0,5

Eingriffswinkel / pressure angle: 20°

Material: Messing (MS58) / Brass

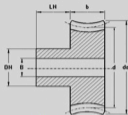

Skizze: E

Best.Nr.	Zähnezahl	d	da	DN	b	LN	B	Skizze
Order No.	Number of teeth							
40512008	8	4,0	5,0	4,0	3,0	4,0	2,0	E
40512010	10	5,0	6,0	4,0	3,0	4,0	2,0	E
40512012	12	6,0	7,0	4,0	3,0	4,0	2,0	E
40512015	15	7,5	8,5	5,0	3,0	4,0	2,0	E
40512018	18	9,0	10,0	5,0	3,0	4,0	2,0	E
40512020	20	10,0	11,0	5,0	3,0	4,0	2,0	E
40512025	25	12,5	13,5	6,0	3,0	4,0	2,0	E
40512030	30	15,0	16,0	6,0	3,0	4,0	2,0	E
40512040	40	20,0	21,0	6,0	3,0	4,0	2,0	E
40512050	50	25,0	26,0	8,0	3,0	4,0	3,0	E
40512075	75	37,5	38,5	8,0	3,0	4,0	3,0	E
40512100	100	50,0	51,0	8,0	3,0	4,0	3,0	E

Alle Abmessungen: mm / all dimensions: mm

Schnecken / Worm
Modul / Module 0,5

Eingriffswinkel / pressure angle: 20°

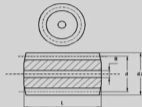

Skizze: F

Best.Nr. Order No.	Zähnezahl / Gangzahl Number of teeth	Material	d	da	L	B	Skizze
40518001	1	Messing / Brass	5,0	6,0	12,0	2,0	F
40528001	1	Stahl / Steel	5,0	6,0	12,0	2,0	F

Alle Abmessungen: mm / all dimensions: mm